

WANDABSORBER

Befestigung mit Magnethalter

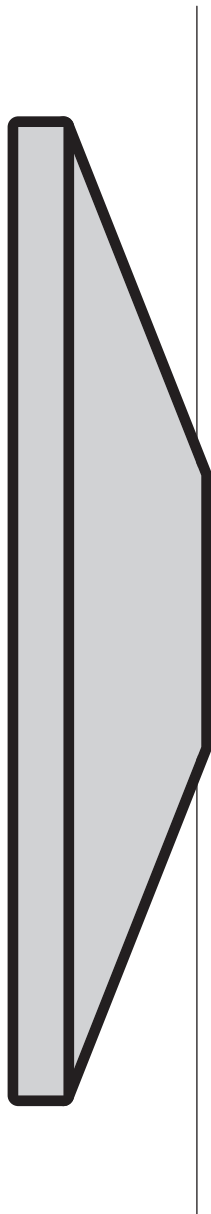

Montageanleitung



Personen

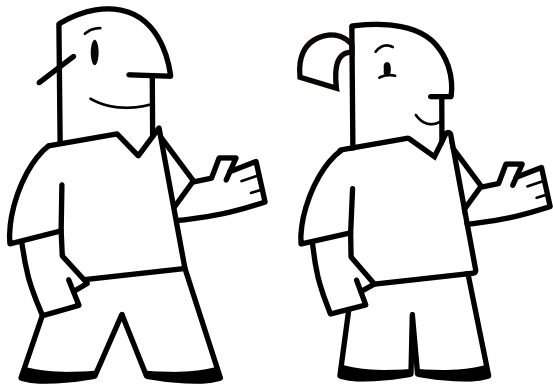

Leitern

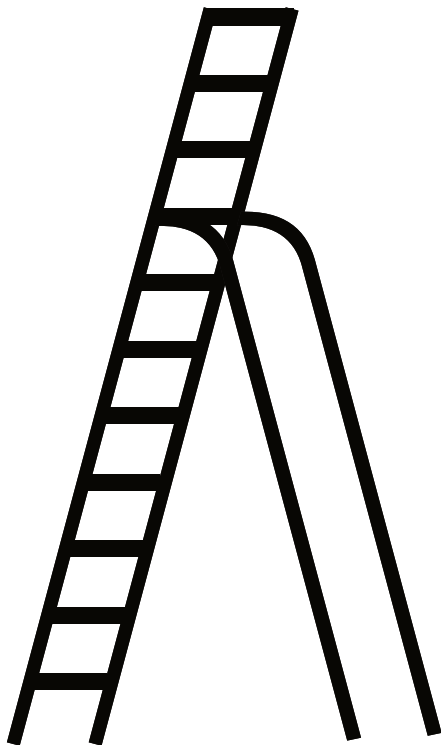

Werkzeug (W)



.W1 - Bleistift

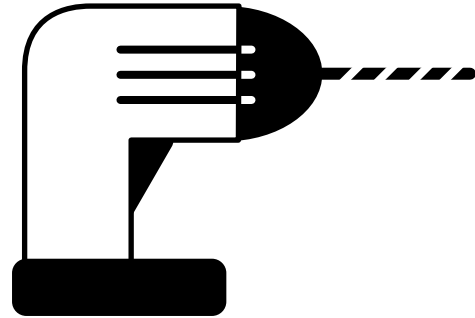

.W2 - Bohrer



.W3- Wasserwaage



.W4 - Schraubendreher



.W5 - Schraubenschlüssel

Wandabsorber (.A)

.A1 - Filzbox / Nitona® mit Aufkantung (außen)



.A2 - Vlies / Bohrschablone (innen)

Befestigungen (.B)

Wand

Filzbox



.B1



.B2 (Magnet)

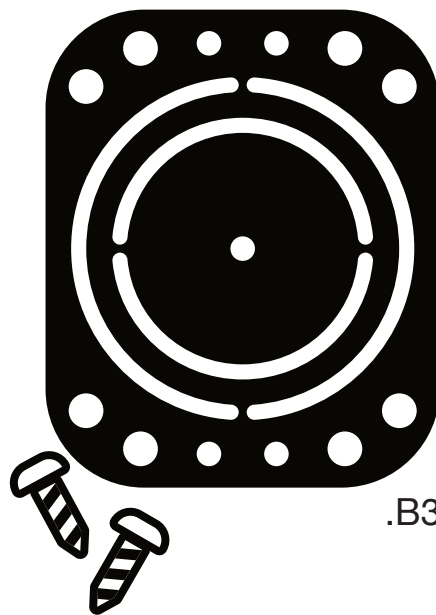

.B3

Zielbild

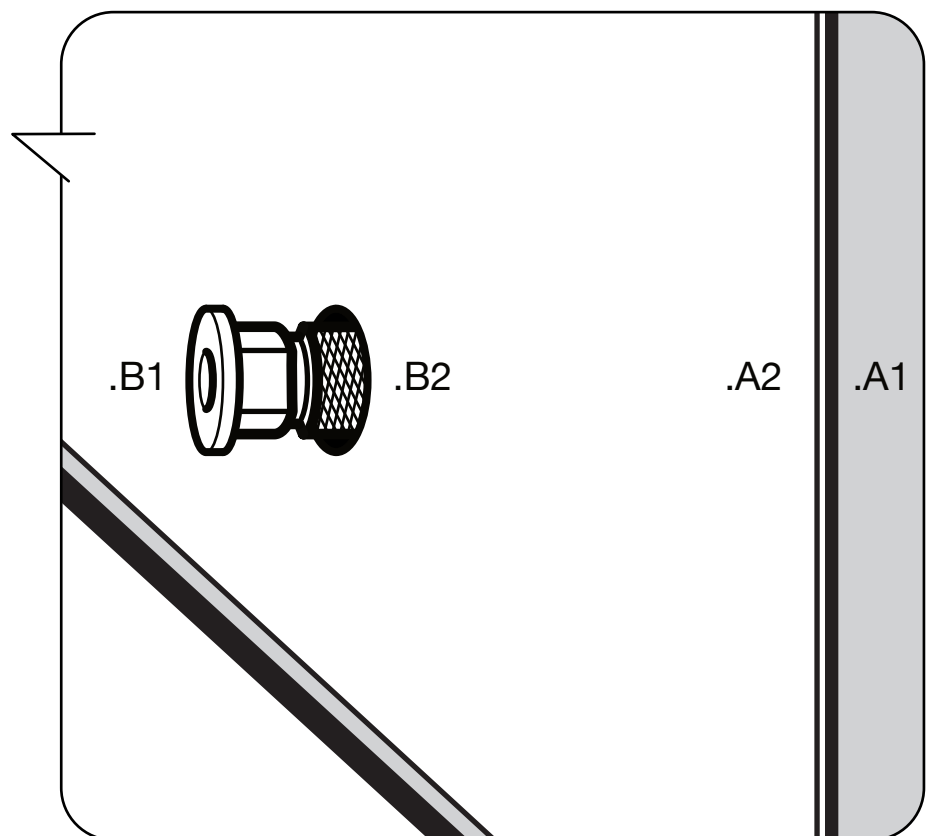
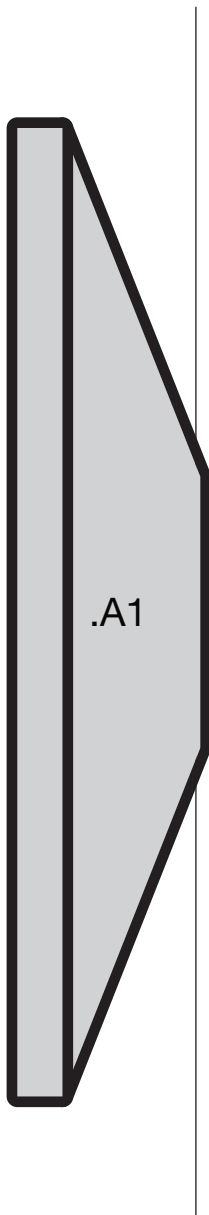

Bohrungen anzeichnen

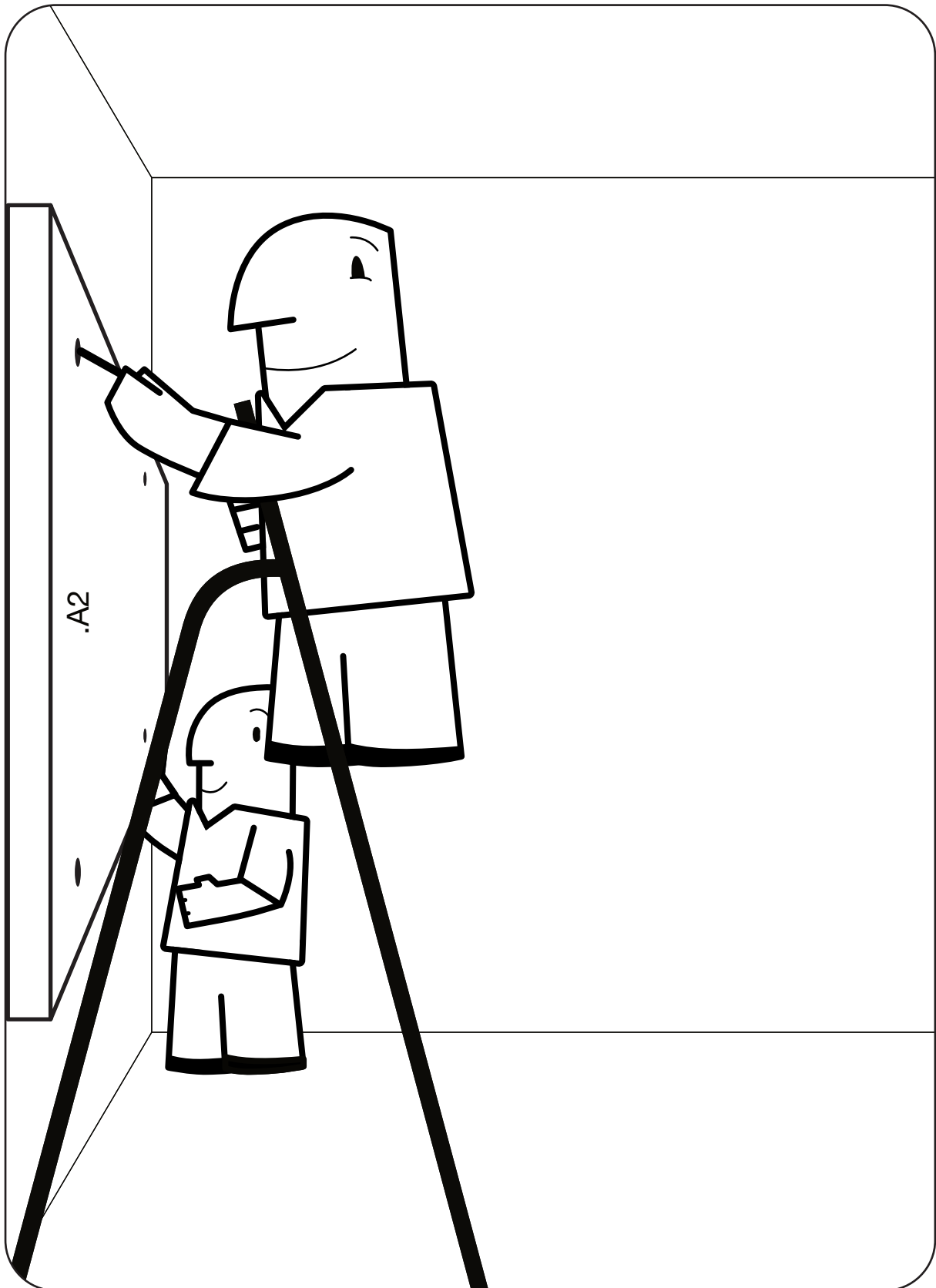

Vlies (.A2) als Bohrschablone

Wandbefestigungen montieren

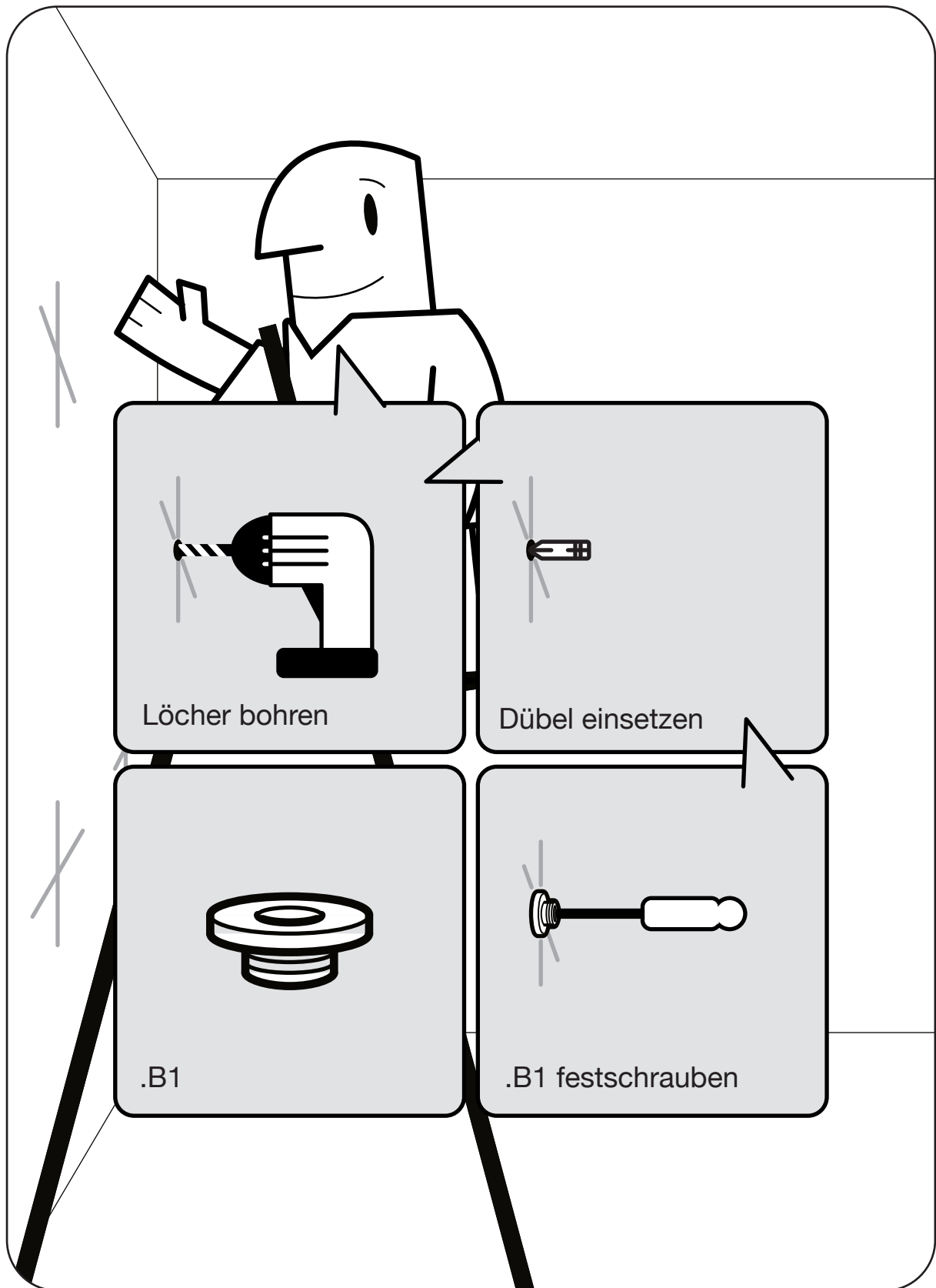

Magnethalter befestigen

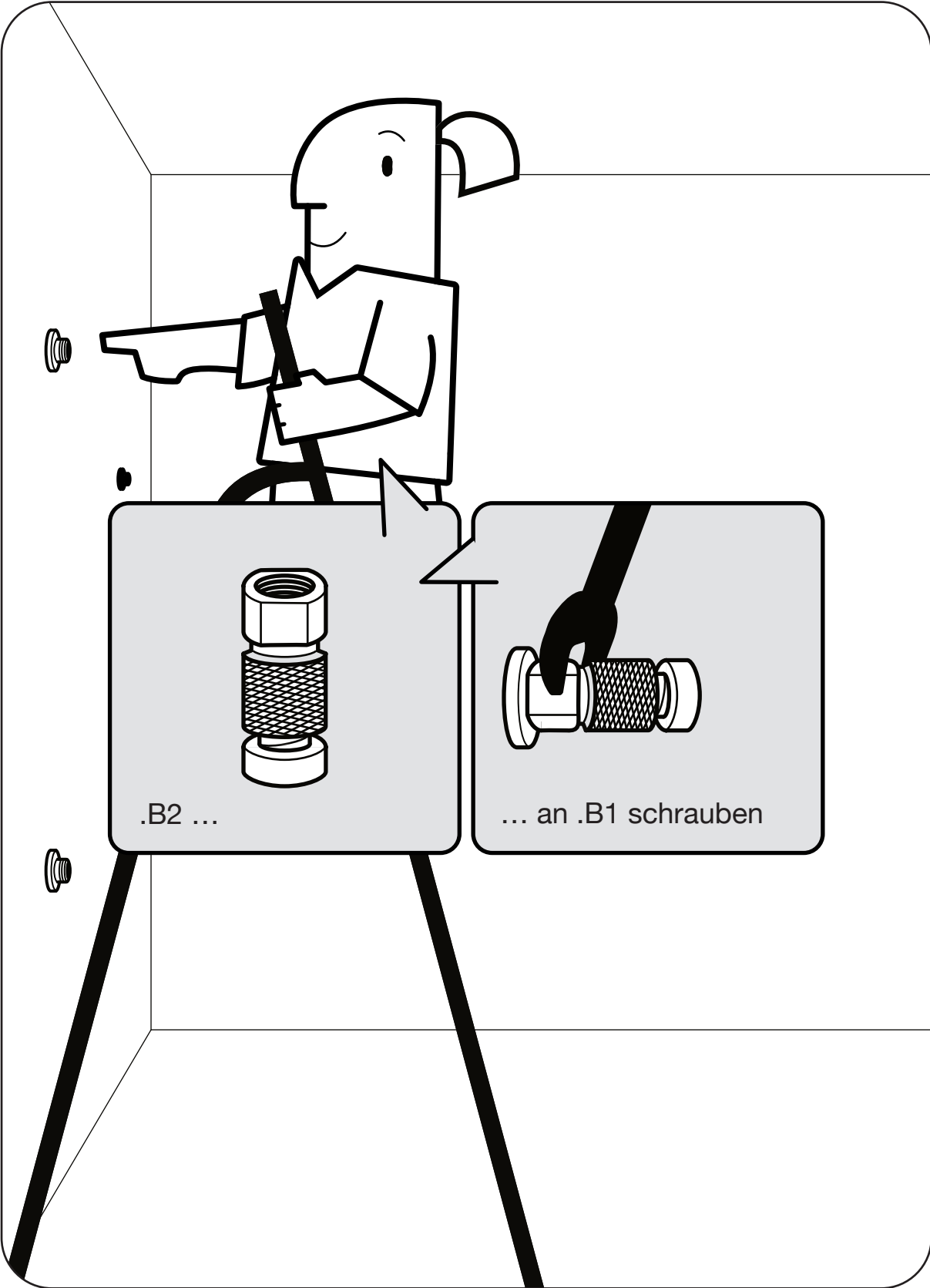

Wandabsorber zusammenbauen

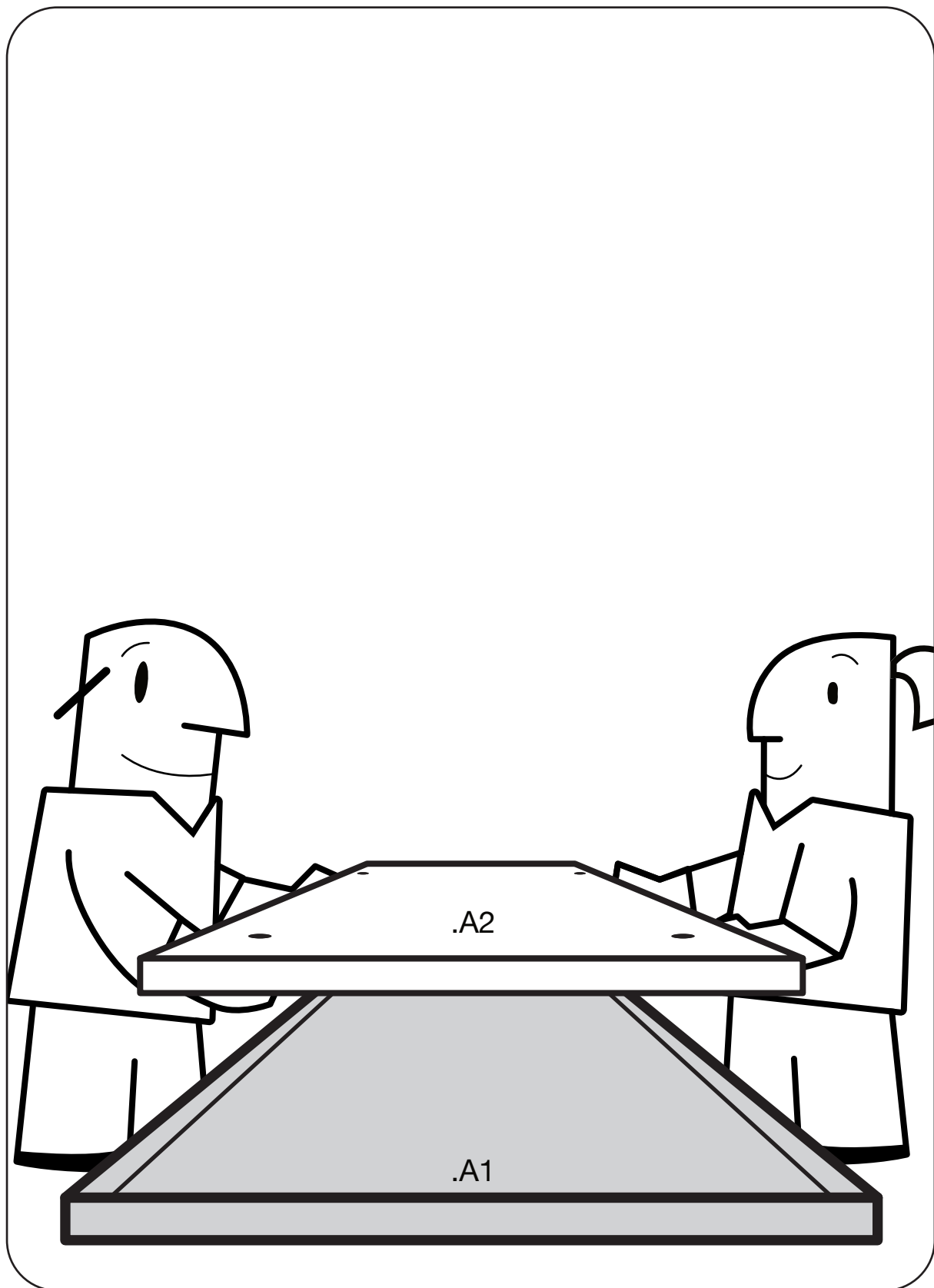

Vlies (.A2) in Filzbox (.A1) legen

Bohrung anzeichnen

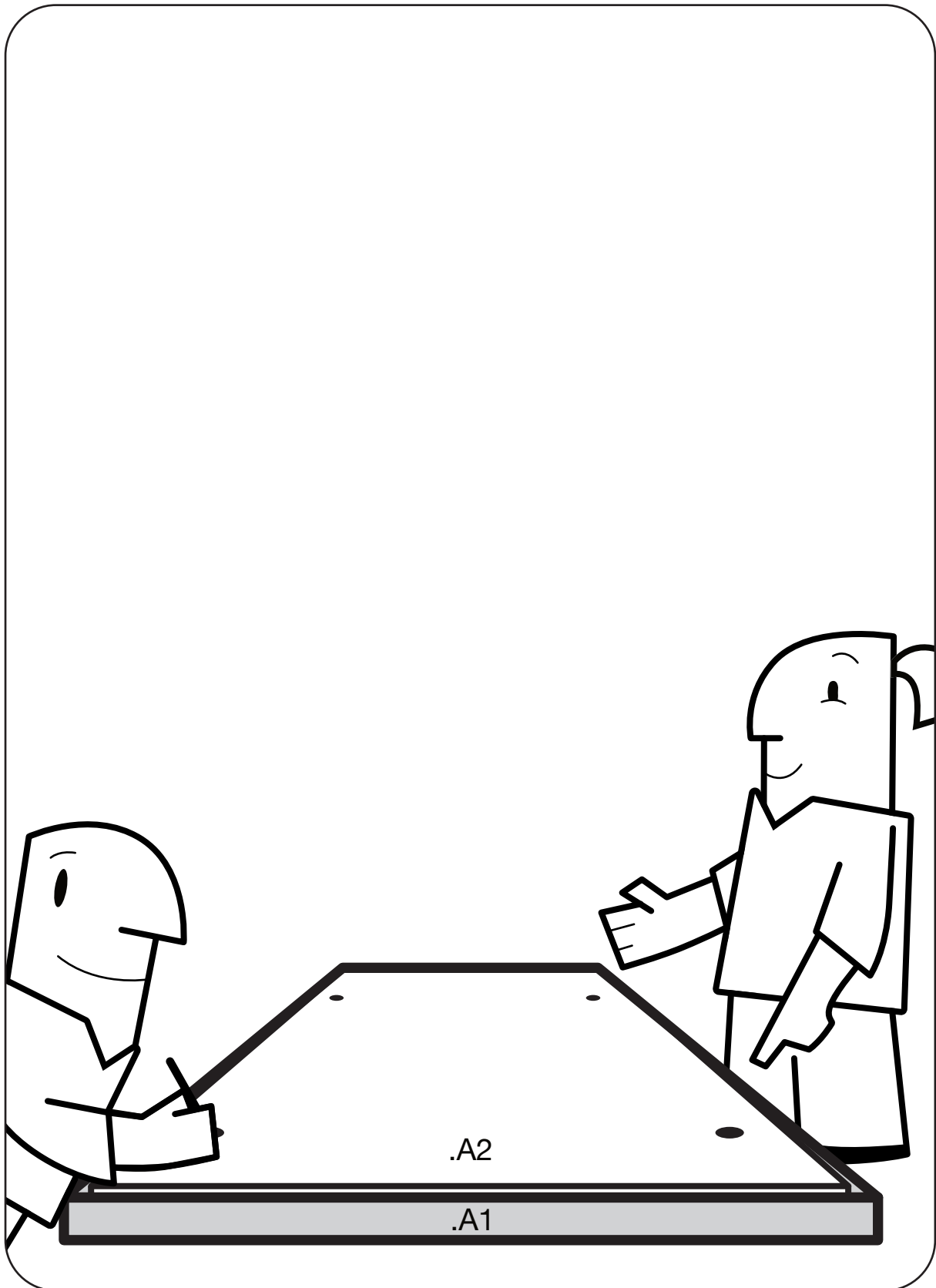

Löcher von Vlies (.A2) auf Filzbox (.A1) zeichnen

Vlies entfernen

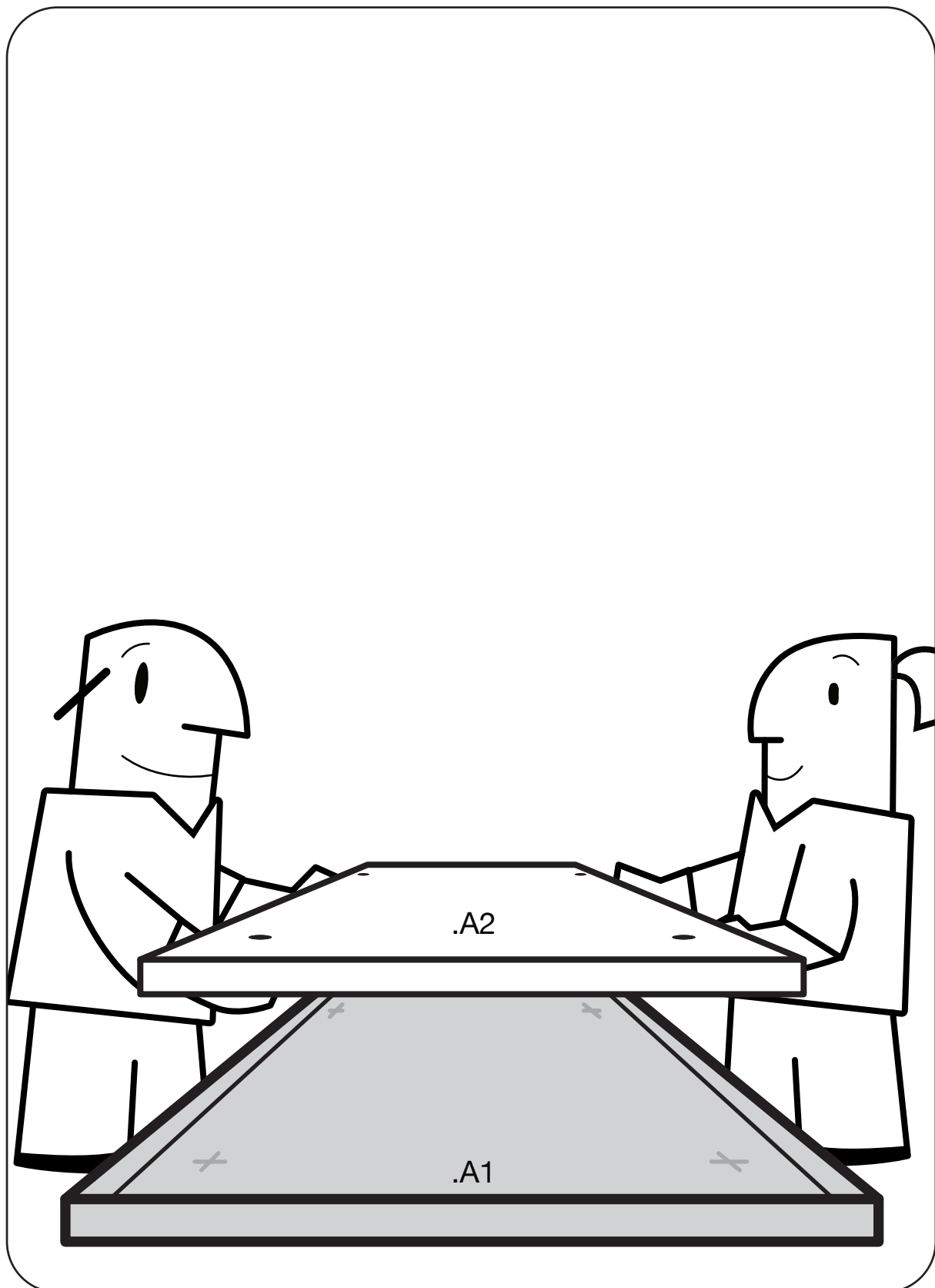

Vlies (.A2) aus Filzbox (.A1) entfernen

Halterungen anschrauben

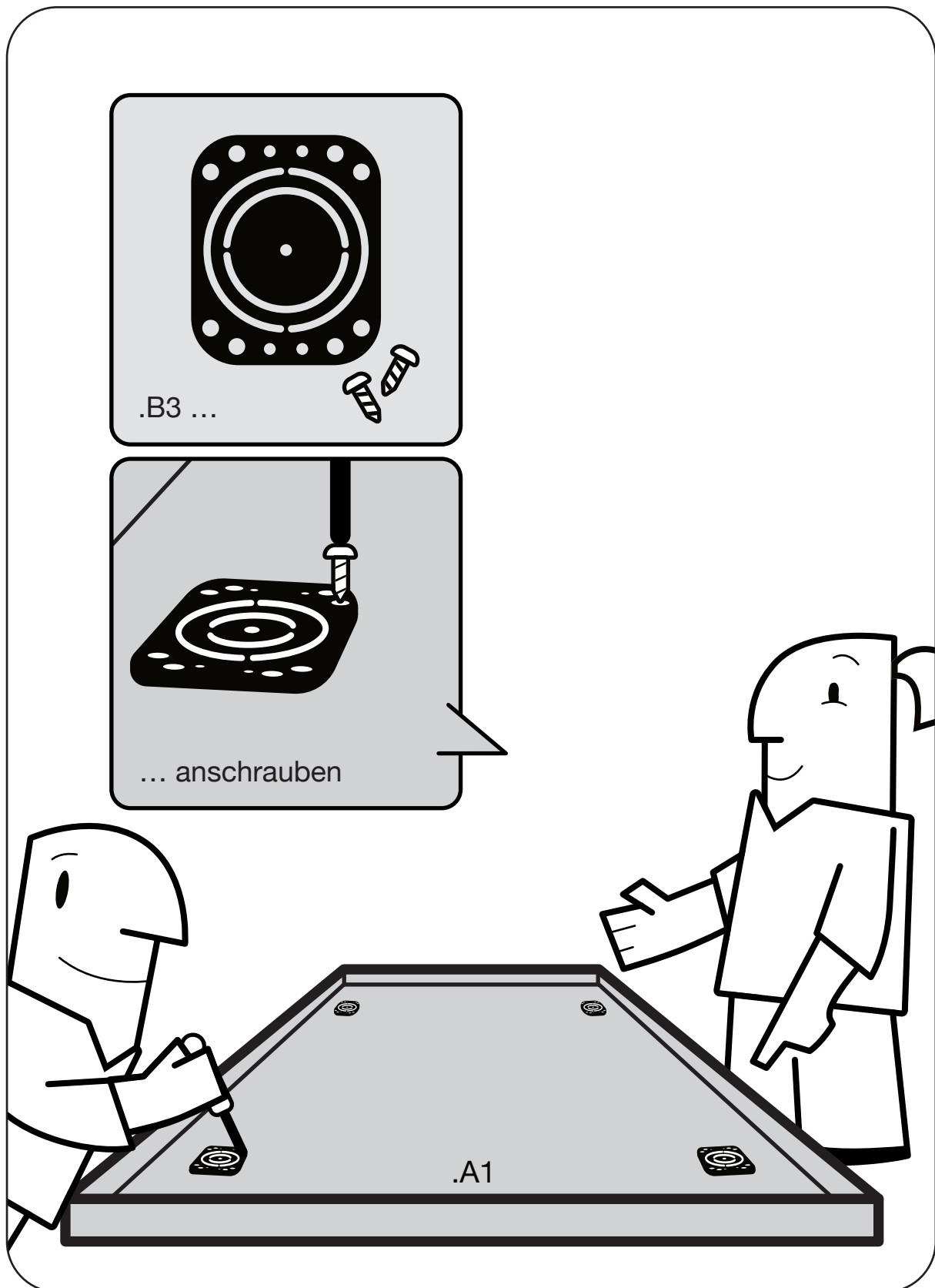

Vlies einlegen

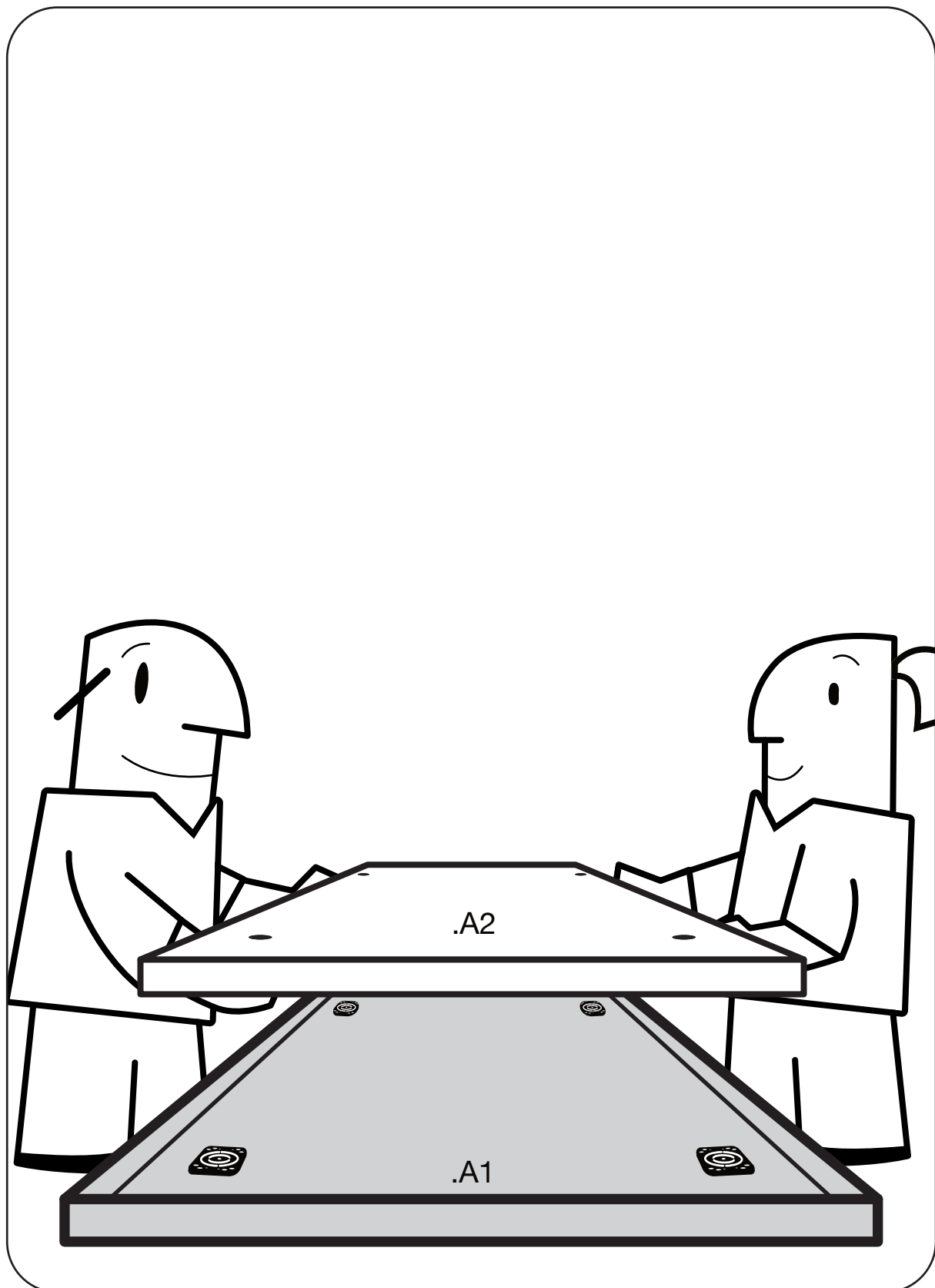

Vlies (.A2) in Filzbox (.A1) legen

Wandabsorber ...

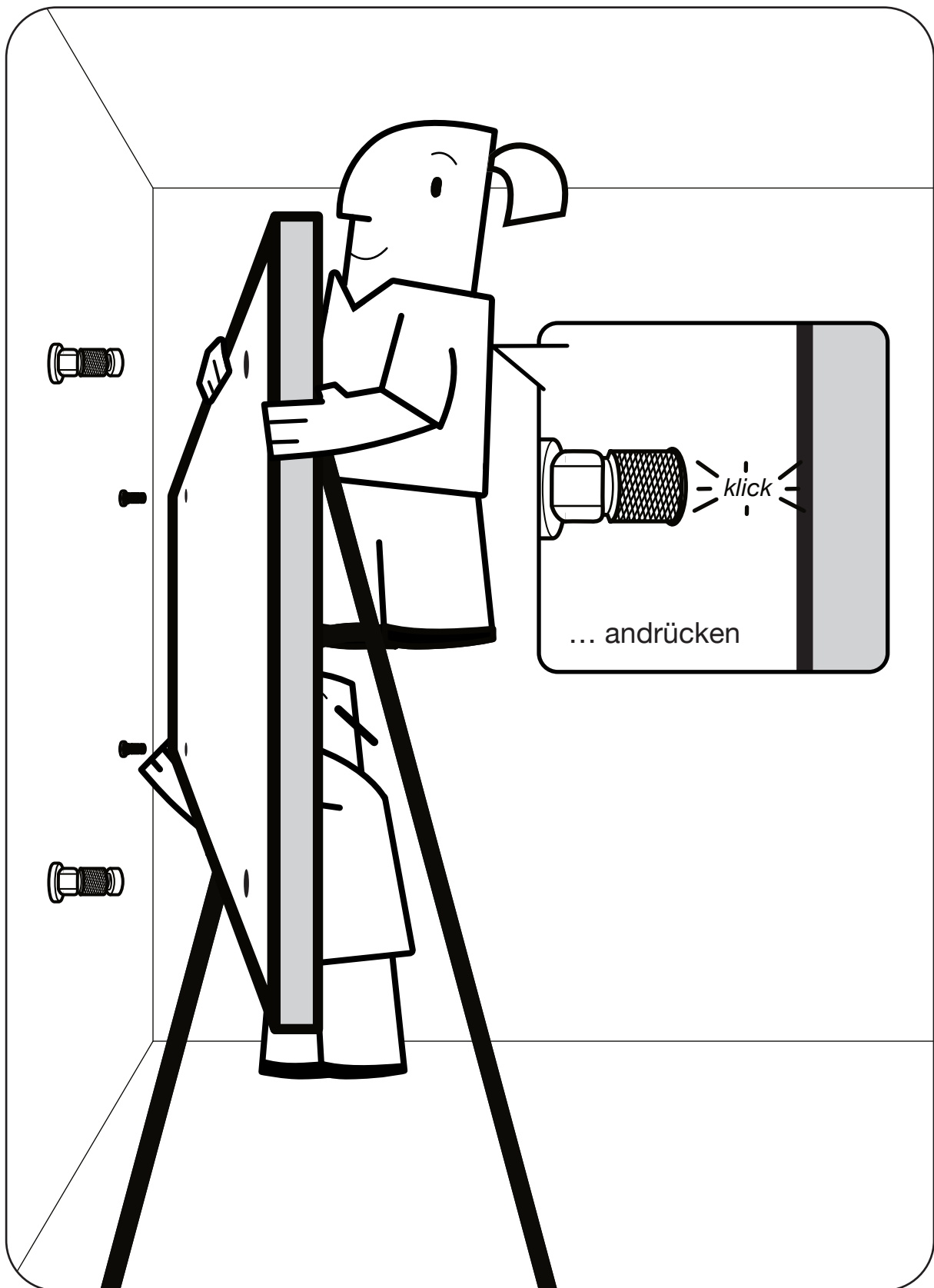

Abstand einstellen

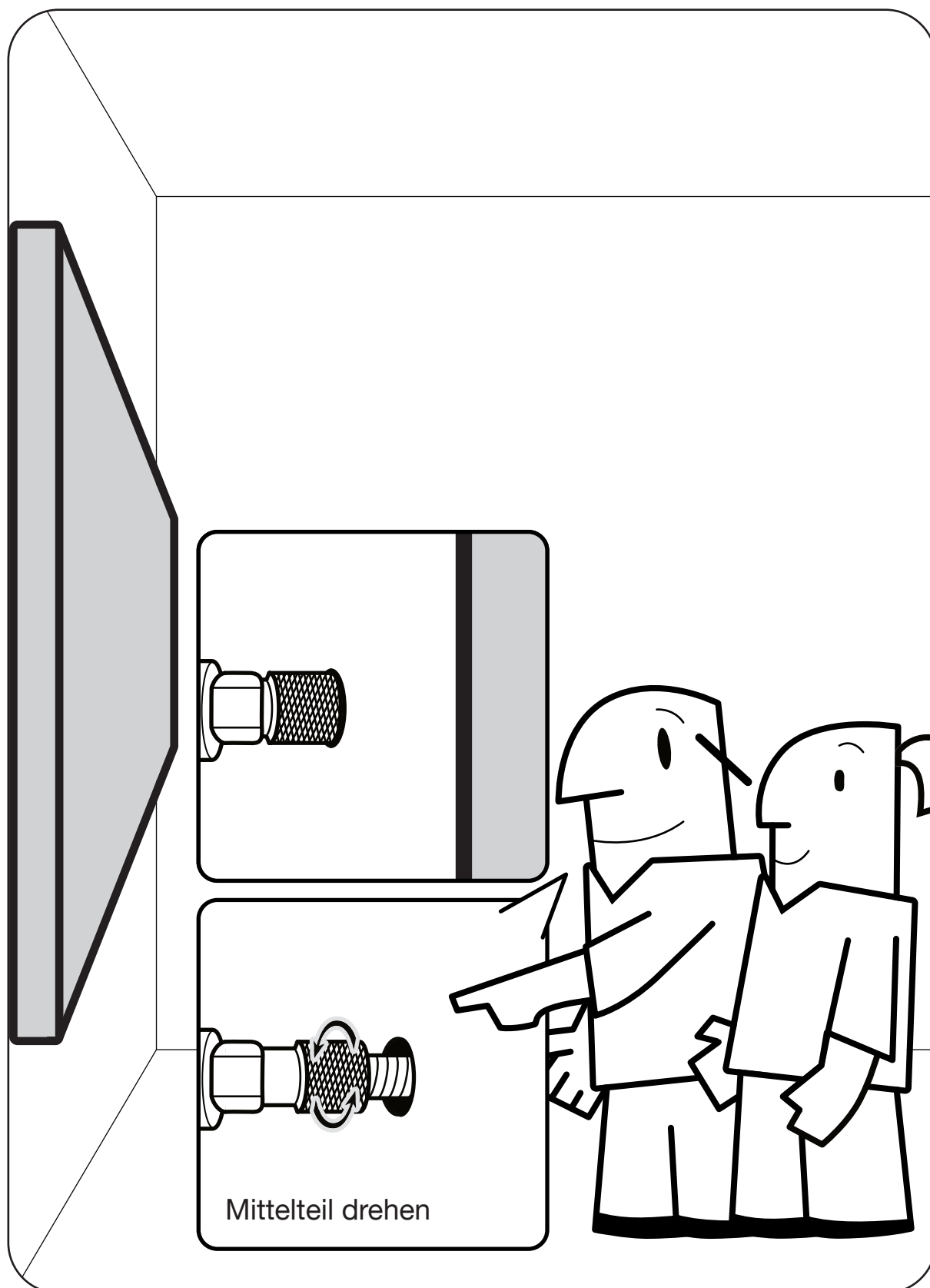



M&K FILZE GMBH

Gewerbepark Hügelmühle 4
91174 Spalt
Germany

Tel.: +49 9175 90778-0
Fax: +49 9175 90778-50

info@filzfabrik.de
www.filzfabrik.de

AKUSTISCHE FILZE

Tel.: +49 (0) 9175 90778-52
Mobil: +49 151 407 543 67
borowski@filzfabrik.de



**DIE MONTAGE
ALS
VIDEO-ANLEITUNG**